

1 hr fire rated, 30 Rw, Pair leaf, Acoustic/Smoke/Fire doorset

DESCRIPTION

Pyropanel AP-30-PAN-E is a 1 hr fire rated, 30 Rw, 48mm nom. acoustic pair doorset that utilises a Pyropanel Euroseal® concealed perimeter seal, and a Pyropanel J-section meeting stile (with fin seals) and an approved bottom seal.

APPLICATIONS

Ideal for anywhere that requires an acoustic rating of 30 Rw and 1hr fire resistance in a pair configuration.

FEATURES

Acoustic Rating

- 30 Rw.

Fire Resistance

- -/60/30

Smoke Resistance

- Meets the NCC requirement for a smoke door.

Door Configuration

- Single-acting, pair configuration, hung in a steel or timber frame.

Perimeter Seal

- Pyropanel Euroseal® concealed smoke / acoustic seal.

Bottom Seal

- See seal combinations listed on page 2.

Meeting Stile

- Pyropanel J-section meeting stile (fin seals to each astragal)

Thickness

- 48mm (nominal)

Door Weight

- Approx 21 kg/m²

Size

- Maximum Size (overall) - 2420mm high x 1020/1020mm wide.

Frame

- Pyropanel Euroseal KDHW Timber or Steel frame (filled).

Finish

- MDF as standard.

OPTIONAL EXTRAS

- Pre-hung in steel or timber frame.
- Ply, veneer, steel or laminate facings.
- Vision panels - 300 x 200 or 600 x 100mm nom.
- Kick panels of stainless steel to selected height.

INSTALLATION

Door frame must be tightly sealed against wall structure using Pyropanel Pyroseal fire and acoustic sealant. Steel door frames require packing with fire rated plasterboard, Pyropanel M4 light-weight mortar, concrete or mortar or to achieve the desired acoustic rating.

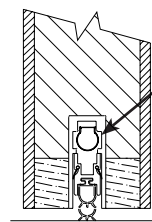
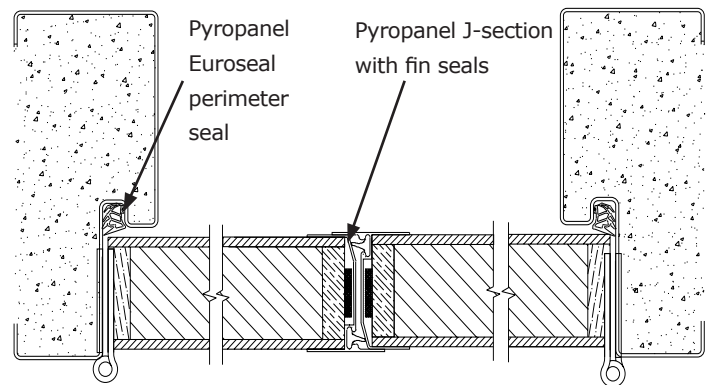

Bottom seal - e.g Lorient LAS8001 (example only. See page 2 for complete list of seals.)

HOW TO SPECIFY

"Door to be a Pyropanel AP-30-PAN-E acoustic pair door, with -/60/30* FRL, installed into a Pyropanel fire rated timber / filled steel* Euroseal door frame, with Pyropanel Euroseal, Pyropanel J-section meeting stile (with fin seals) and Lorient LAS8001* bottom seals".

* denotes example - delete, change or specify as required

ASSA ABLOY Australia Pty Ltd

235 Huntingdale Rd, Oakleigh, Vic 3166

Ph: (03) 9837 8500

Email: sales@pyropanel.com.au

Web: www.pyropanel.com.au

Distributed by:

Solwest Doors

Ph: (08) 9309 3899

Email: sales@solwest.com.au

Web: www.solwest.com.au



ASSA ABLOY**1 hr fire rated, 30 Rw, Pair leaf, Acoustic/Smoke/Fire doorset****SEAL COMBINATIONS**

Door Type	Perimeter Seals	Meeting Stile Seals	Bottom Seals
AP-30-PAN-E	Pyropanel Euroseal	Pyropanel J-section	Lorient LAS8001si
			Lorient LAS8002si
			Lorient LAS8003si
			Lorient LAS8005si
			Lorient LAS8006si
			Lorient LAS8007si
			Lorient LAS8008si
			Lorient LAS8009si

ASSA ABLOY Australia Pty Ltd
235 Huntingdale Rd, Oakleigh, Vic 3166
Ph: **(03) 9837 8500**
Email: sales@pyropanel.com.au
Web: www.pyropanel.com.au

Distributed by:
Solwest Doors
Ph: **(08) 9309 3899**
Email: sales@solwest.com.au
Web: www.solwest.com.au

SOLWEST
DOORS