

2 hr fire rated, 30Rw, Single leaf, Acoustic/Smoke/Fire doorset

DESCRIPTION

Pyropanel AS-30-FRB-E is a 30 Rw, 2 hour fire rated 48mm nominal single leaf acoustic doorset that utilises a Pyropanel Euroseal® concealed perimeter seal and an approved bottom seal.

APPLICATIONS

Ideal for applications that require up to 2 hours of fire resistance and an acoustic rating of 30 Rw.

FEATURES

Acoustic Rating

- 30 Rw

Fire Resistance

- Up to FRL -/120/30

Smoke Resistance

- Meets the NCC requirement for a smoke door.

Door Configuration

- Single leaf

Thickness

- 48mm (nominal)

Door Weight

- Approx 22 kg/m²

Size

- Maximum Size - 2700 x 1500mm (For Masonry, Concrete, Hebel and Plasterboard Walls).
- For other wall types, please contact your preferred Pyropanel distributor.

Frame

- Pyropanel filled Euroseal steel frame or Pyropanel fire rated timber frame (timber frame limited to 1hr applications, i.e -/60/30 and maximum door size of 2700 x 1020mm).

Finish

- Plywood / MDF / Hardboard

Perimeter Seals

- Pyropanel Euroseal® concealed smoke/acoustic seal.

Bottom Seals

- See seal combinations listed on page 2.

OPTIONAL EXTRAS

- Pre-hung in steel or timber frame.
- Approved veneer, steel or laminate facings.
- Pyropanel Pyrodur 13mm thick vision panels - 300 x 200 or 600 x 100mm nom. (Rw 38)
- Note: Fire rating may be reduced by some of the optional extras. Contact your preferred distributor for clarification.

INSTALLATION

Door frame must be tightly sealed to wall structure using Pyropanel Pyroseal sealant. Steel door frames require packing with fire rated plasterboard, Pyropanel light-weight M4 Mortar, concrete or mortar to achieve the desired acoustic rating.

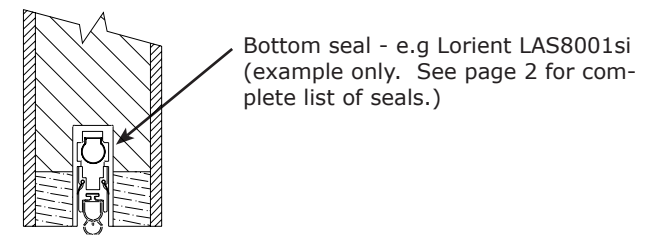
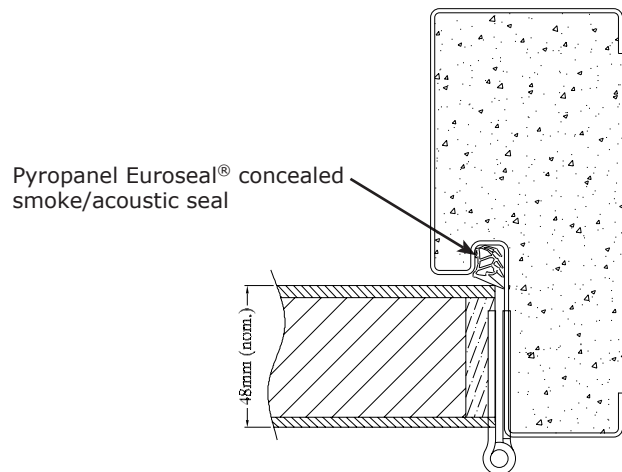

HOW TO SPECIFY

"Door to be a Pyropanel AS-30-FRB-E acoustic door with -/120/30* FRL, installed into a Pyropanel filled Euroseal® steel* door frame, with Pyropanel Euroseal and Lorient LAS8001si* seals".

* denotes example - delete, change or specify as required

ASSA ABLOY Australia Pty Ltd

235 Huntingdale Rd, Oakleigh, Vic 3166

Ph: (03) 9837 8500

Email: sales@pyropanel.com.au

Web: www.pyropanel.com.au

Distributed by:

Solwest Doors

Ph: (08) 9309 3899

Email: sales@solwest.com.au

Web: www.solwest.com.au

SOLWEST
DOORS

2 hr fire rated, 30Rw, Single leaf, Acoustic/Smoke/Fire doorset

SEAL COMBINATIONS

Door Type	Perimeter Seals	Bottom Seals
AS-30-FRB-E	Pyropanel Euroseal®	Lorient LAS8001si
		Lorient LAS8002si
		Lorient LAS8003si
		Lorient LAS8005si
		Lorient LAS8006si
		Lorient LAS8007si
		Lorient LAS8008si
		Lorient LAS8009si

ASSA ABLOY AUSTRALIA Pty Ltd
235 Huntingdale Rd, Oakleigh, Vic 3166
Ph: **(03) 9837 8500**
Email: sales@pyropanel.com.au
Web: www.pyropanel.com.au

Distributed by:
Solwest Doors
Ph: **(08) 9309 3899**
Email: sales@solwest.com.au
Web: www.solwest.com.au

SOLWEST
DOORS