

## 2 hr fire rated, 30Rw, Single leaf, Acoustic/Smoke/Fire doorset

### DESCRIPTION

Pyropanel AS-30-FRB-E is a 30 Rw, 2 hour fire rated 48mm nominal single leaf acoustic doorset that utilises a Pyropanel Euroseal® concealed perimeter seal and an approved bottom seal.

### APPLICATIONS

Ideal for applications that require up to 2 hours of fire resistance and an acoustic rating of 30 Rw.

### FEATURES

#### Acoustic Rating

- 30 Rw

#### Fire Resistance

- Up to FRL -/120/30

#### Smoke Resistance

- Meets the NCC requirement for a smoke door.

#### Door Configuration

- Single leaf

#### Thickness

- 48mm (nominal)

#### Door Weight

- Approx 22 kg/m<sup>2</sup>

#### Size

- Maximum Size - 2700 x 1500mm (For Masonry, Concrete, Hebel and Plasterboard Walls).
- For other wall types, please contact your preferred Pyropanel distributor.

#### Frame

- Pyropanel filled Euroseal steel frame or Pyropanel fire rated timber frame (timber frame limited to 1hr applications, i.e -/60/30 and maximum door size of 2700 x 1020mm).

#### Finish

- Plywood / MDF / Hardboard

#### Perimeter Seals

- Pyropanel Euroseal® concealed smoke/acoustic seal.

#### Bottom Seals

- See seal combinations listed on page 2.

### OPTIONAL EXTRAS

- Pre-hung in steel or timber frame.
- Approved veneer, steel or laminate facings.
- Pyropanel Pyrodur 13mm thick vision panels - 300 x 200 or 600 x 100mm nom. (Rw 38)
- Note: Fire rating may be reduced by some of the optional extras. Contact your preferred distributor for clarification.

### INSTALLATION

Door frame must be tightly sealed to wall structure using Pyropanel Pyroseal sealant. Steel door frames require filling with fire rated plasterboard, Pyropanel light-weight M4 Mortar, concrete or mortar to achieve the desired acoustic rating.

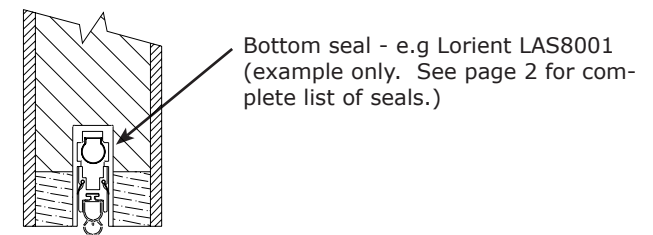
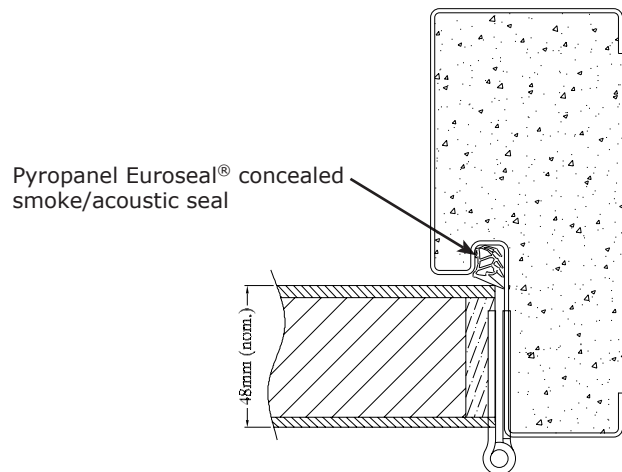

### HOW TO SPECIFY

"Door to be a Pyropanel AS-30-FRB-E acoustic door with -/120/30\* FRL, installed into a Pyropanel filled Euroseal® steel\* door frame, with Pyropanel Euroseal and Lorient LAS8001\* seals".

\* denotes example - delete, change or specify as required

#### ASSA ABLOY Australia Pty Ltd

235 Huntingdale Rd, Oakleigh, Vic 3166

Ph: (03) 9837 8500

Email: [sales@pyropanel.com.au](mailto:sales@pyropanel.com.au)

Web: [www.pyropanel.com.au](http://www.pyropanel.com.au)

#### Distributed by:

**Solwest Doors**

Ph: (08) 9309 3899

Email: [sales@solwest.com.au](mailto:sales@solwest.com.au)

Web: [www.solwest.com.au](http://www.solwest.com.au)



## 2 hr fire rated, 30Rw, Single leaf, Acoustic/Smoke/Fire doorset

### SEAL COMBINATIONS

Door Type	Perimeter Seals	Bottom Seals
AS-30-FRB-E	Pyropanel Euroseal®	Lorient LAS8001
		Lorient LAS8002
		Lorient LAS8003
		Lorient LAS8005
		Lorient LAS8006
		Lorient LAS8007
		Lorient LAS8008
		Lorient LAS8009

**ASSA ABLOY AUSTRALIA Pty Ltd**

235 Huntingdale Rd, Oakleigh, Vic 3166

Ph: **(03) 9837 8500**Email: [sales@pyropanel.com.au](mailto:sales@pyropanel.com.au)Web: [www.pyropanel.com.au](http://www.pyropanel.com.au)**Distributed by:****Solwest Doors**Ph: **(08) 9309 3899**Email: [sales@solwest.com.au](mailto:sales@solwest.com.au)Web: [www.solwest.com.au](http://www.solwest.com.au)**SOLWEST**  
DOORS