

# ASSA ABLOY

## 44 Rw, Single leaf, Acoustic Doorset (not fire rated)

### DESCRIPTION

Pyropanel AS-44-PAC is a single leaf, 44 Rw acoustic doorset.

### APPLICATIONS

Ideal for applications that require an acoustic rating of 44 Rw.

### FEATURES

#### Acoustic Rating

- 44 Rw.

#### Smoke Resistance

- Doorset is fitted with smoke seals.

#### Door Configuration

- Single leaf.

#### Thickness

- 73mm-78mm nom. (depending on the facing thickness).

#### Door Weight

- Approx 53 kg/m<sup>2</sup>

#### Size

- Maximum Size - 2340 x 1020mm.

#### Hinges

- Minimum 4 steel hinges.

#### Frame

- Pyropanel Euroseal filled steel frame (1.6mm), with Pyropanel light weight M4 Mortar.

#### Finish

- MDF or Hardboard facing to both faces.

#### Seal combinations

Door Type	Perimeter	Bottom	Corner	Rw
AS-44-PAC	Pyropanel Euroseal + Lorient LAS7001si	Pyropanel PY-BSI	Pyropanel PY-CS1	44

### OPTIONAL EXTRAS

- Decorative veneers.
- Pyropanel 13mm thick Vision panels - 300 x 200 or 600 x 100mm nom. (Rw 38). Note - The inclusion of a vision panel will cause a slight reduction in acoustic rating.

### INSTALLATION

Door frame, door leaf & door seals should be sourced from a Pyropanel Authorised Licensee as a complete set. Door frame must be tightly sealed against wall structure using Pyropanel Pyropanel acoustic sealant. Steel frames require backfilling with Pyropanel light-weight M4 Mortar to achieve the acoustic rating.

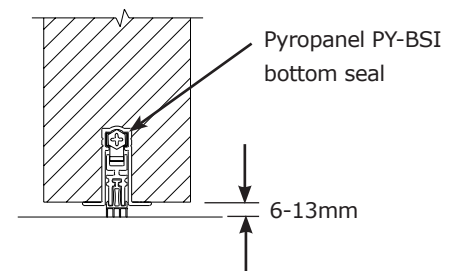
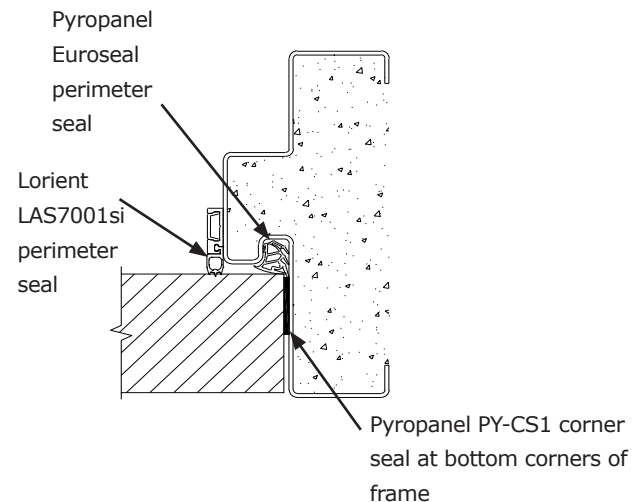

### HOW TO SPECIFY

"Doorset to be a Pyropanel AS-44-PAC acoustic door, installed into a Pyropanel Euroseal filled steel door frame".